

Componenti in acciaio stampato zincati galvanicamente.  
Rotazione piastra su doppia corona di sfere in acciaio temperato.

Piste rotazione sfere calibrate e lubrificate.  
Anello di protezione sfere antipolvere.  
Perno ribadito per assemblaggio supporto.  
Frenature integrali a pedale regolabile.

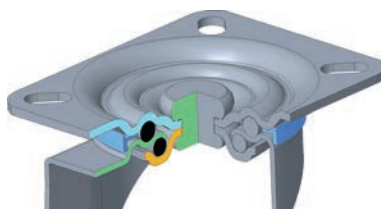

*Pressed steel, zinc-plated components.  
Double ball races with hardened steel balls.  
Calibrated and lubricated ball race tracks.  
Dust protection ring.  
Riveted or bolted central pin for assembling.  
Adjustable brake foot lever.*

girevole piastra / swivel castor

## AKCIJA SERIE CXH

**Cena: 10,00 EUR**

cene so brez DDV

## SERIE CXH



girevole foro per vite / bolt hole swivel castor



125x30	12	77	35	156	180	1CXH-1250QR0	180	3251
--------	----	----	----	-----	-----	--------------	-----	------

Varianti/Options

**Zaloge omejene!**



## CARATTERISTICHE





Vengono realizzate con nucleo in nylon 6 e ricopertura in poliuretano termoplastico; assicurano una completa protezione dei pavimenti ed una totale assenza di rumore pur utilizzando un battistrada di durezza relativamente elevata (98 Shore A). Hanno un'ottima resistenza all'abrasione, agli oli minerali ed ai grassi. Possono presentare limitazioni di impiego in presenza di vapore acqueo. La temperatura d'impiego va da -20°C a +60°C

## FEATURES

Made with a core of nylon 6 and a coating of thermoplastic polyurethane; these wheels ensure a complete protection of floors and a total absence of noise while using a tread of relatively high hardness (98 Shore A). They have excellent resistance to abrasion, mineral oils and greases. May have limitations for use in the presence of water vapor. The operating temperature ranges from -20°C to +60°C.

## SERIE CXH

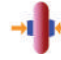

ART. (CODE)					
080 CXH (40080H01)	80	30	40	8	120
081 CXH (40080H02)	80	30	45	8	120
100 CXH (40100H04)	100	30	40	8	170
101 CXH (40100H05)	100	30	45	8 - 10	170
102 CXH (40100H03)	100	35	45	8 - 10	200
125CXH (40125H01)	125	35	45	8 - 10	180