

Componenti in acciaio stampato zincati galvanicamente.  
 Rotazione piastra su doppia corona di sfere in acciaio temperato.  
 Piste rotazione sfere calibrate e lubrificate.  
 Anello di protezione sfere antipolvere.  
 Perno ribadito per assemblaggio supporto.  
 Frenature integrali a pedale regolabile.

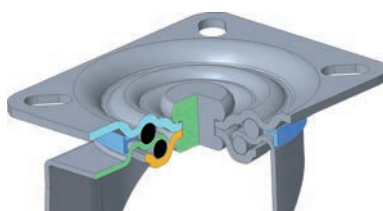

*Pressed steel, zinc-plated components.  
 Double ball races with hardened steel balls.  
 Calibrated and lubricated ball race tracks.  
 Dust protection ring.  
 Rivetted or bolted central pin for assembling.  
 Adjustable brake foot lever.*

girevole piastra / swivel castor



80x35	105x85	80x60	9x16	38	108	COD		COD		samo v sivi barvi	
						<b>1NGR100SGRO</b>	120			1FHN100SGRO	120
<b>100x32</b>	105x85	80x60	9x16	38	128	<b>1NGE100LGR0</b>	180				
<b>100x38</b>	105x85	80x60	9x16	45	128	<b>1NGE125LGR0</b>	180	<b>1NGT125LGR0</b>	180	1FHN125LGR0	160
<b>125x40</b>	105x85	80x60	9x16	45	155	<b>1NGE160LGR0</b>	300	<b>1NGT160LGR0</b>	300	1FHN160LGR0	250
<b>160x50</b>	135x110	105x80	11x16	55	199	<b>1NGE200GRO</b>	300	<b>1NGT200GRO</b>	300	1FHN200GRO	250
<b>200x50</b>	135x110	105x80	11x16	55	239						
<b>250x50</b>	135x110	105x80	11x16	55	290			<b>1NGT2500GMO</b>	350	1FHN2500GMO	300

girevole piastra freno pedale anteriore regolabile / swivel castor with adjustable front brake foot lever



80x35	105x85	80x60	9x16	38	108	120	COD		COD		samo v sivi barvi	
							<b>1NGR100SGRI</b>	120			1FHN100SGRI	120
<b>100x32</b>	105x85	80x60	9x16	38	128	120	<b>1NGE100LGR0</b>	180				
<b>100x38</b>	105x85	80x60	9x16	45	128	120	<b>1NGE125LGR0</b>	180	<b>1NGT125LGR0</b>	180	1FHN125LGR0	160
<b>125x40</b>	105x85	80x60	9x16	45	155	120	<b>1NGE160LGR0</b>	300	<b>1NGT160LGR0</b>	300	1FHN160LGR0	250
<b>160x50</b>	135x110	105x80	11x16	55	199	140	<b>1NGE200GRI</b>	300	<b>1NGT200GRI</b>	300	1FHN200GRI	250
<b>200x50</b>	135x110	105x80	11x16	55	239	140						
<b>250x50</b>	135x110	105x80	11x16	55	290				<b>1NGT2500GMI</b>	350	1FHN2500GMI	300

girevole foro per vite / bolt hole swivel castor



80x35	12	77	38	104	COD		COD		samo v sivi barvi		
						<b>1NGR100SQRO</b>	120			1FHN100SQRO	120
<b>100x32</b>	12	77	38	124	<b>1NGE100LQRO</b>	180					
<b>100x38</b>	12	77	45	124	<b>1NGE125LQRO</b>	180	<b>1NGT125LQRO</b>	180	1FHN125LQRO	160	
<b>125x40</b>	12	77	45	151	<b>1NGE160LQRO</b>	300	<b>1NGT160LQRO</b>	300	1FHN160LQRO	250	
<b>160x50</b>	16	103	55	193	<b>1NGE200QRO</b>	300	<b>1NGT200QRO</b>	300	1FHN200QRO	250	
<b>200x50</b>	16	103	55	233							

girevole foro per vite freno pedale anteriore regolabile / bolt hole swivel castor with adjustable front brake foot lever



80x35	12	77	38	104	120 <th>COD</th> <th></th> <th>COD</th> <th></th> <th>samo v sivi barvi</th> <th></th>	COD		COD		samo v sivi barvi	
						<b>1NGR100SQRI</b>	120			1FHN100SQRI	120
<b>100x32</b>	12	77	38	124	120	<b>1NGE100LQRI</b>	180				
<b>100x38</b>	12	77	45	124	120	<b>1NGE125LQRI</b>	180	<b>1NGT125LQRI</b>	180	1FHN125LQRI	160
<b>125x40</b>	12	77	45	151	120	<b>1NGE160LQRI</b>	300	<b>1NGT160LQRI</b>	300	1FHN160LQRI	250
<b>160x50</b>	16	103	55	193	140	<b>1NGE200QRI</b>	300	<b>1NGT200QRI</b>	300	1FHN200QRI	250
<b>200x50</b>	16	103	55	233	140						

fisso piastra / fixed castor



80x35	105x85	80x60	9x16	108	COD		COD		samo v sivi barvi		
						<b>1NGR100SFIO</b>	120			1FHN100SFIO	120
<b>100x32</b>	105x85	80x60	9x16	128	<b>1NGE100LFIO</b>	120					
<b>100x38</b>	105x85	80x60	9x16	128	<b>1NGE125LFIO</b>	120	<b>1NGT125LFIO</b>	120	1FHN125LFIO	160	
<b>125x40</b>	105x85	80x60	9x16	155	<b>1NGE160LFIO</b>	300	<b>1NGT160LFIO</b>	300	1FHN160LFIO	250	
<b>160x50</b>	135x110	105x80	11x16	199	<b>1NGE200FIO</b>	300	<b>1NGT200FIO</b>	300	1FHN200FIO	250	
<b>200x50</b>	135x110	105x80	11x16	239							
<b>250x50</b>	135x110	105x80	11x16	290			<b>1NGT2500FMO</b>	350	1FHN2500FMO	300	



RUOTE NUCLEO POLIAMMIDE ANELLO GOMMA BLU O GRIGIA ELASTICA ANTITRACCIA

POLYAMIDE CENTRE WHEELS WITH BLUE OR GREY NON-MARKING ELASTIC RUBBER TYRES

### Caratteristiche Ruota

Anello gomma blu ELASTICA antitraccia **NG**  
 Anello gomma grigia ELASTICA antitraccia **NH**  
 Struttura portante in poliammide colore nero.  
 Movimento mozzo:  
 gabbia a rulli.  
 gabbia a rulli con pista di scorrimento in acciaio.  
 doppi cuscinetti a sfera tenuta stagna.  
 Temperatura d'impiego da -10°C a +60°C.  
 Buona resistenza agli aggressivi chimici.  
 Durezza battistrada 65 Sh.A +/- 5.  
 Ottima resistenza all'abrasione.  
 Velocità massima di lavoro 4 km/h.  
 Mezzo di trazione consigliato: manuale.

### Wheel Features

Blue non-marking ELASTIC rubber tyre **NG**  
 Grey non-marking ELASTIC rubber tyre **NH**  
 Black polyamide centre wheel.  
 Type of bearing:  
 roller bearing.  
 roller bearing with steel tube.  
 double waterproof ball bearings  
 Temperature range: from -10°C to +60°C.  
 Good resistance to chemicals.  
 Tread hardness 65 Sh.A +/- 5.  
 Very good resistance to abrasion.  
 Max. working speed 4 KPH.  
 Operation: manual.



MN Anello in gomma grigia elastica antistatica  
 Antistatic elastic grey rubber tyre

### Pavimentazioni Idonee / Floring Type

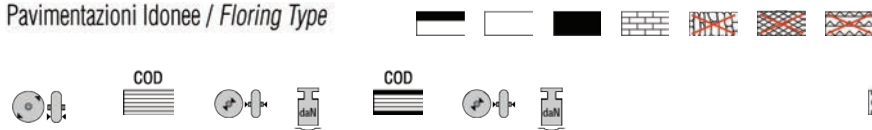

### Varianti / Options



Parafili in poliammide  
 Polyamide thread guards



Parafili in lega leggera  
 Light Metal thread guards

100x32 ONGR100S12 12x40 160

100x38 ONGE100L15 15x46 200

125x40 ONGE125L15 15x46 225 ONGT125L15 15x47 30 225

160x50 ONGE160L20 20x60 300 ONGT160L20 20x61 40 300

200x50 ONGE200020 20x60 400 ONGT200020 20x61 40 400

250x50 ONGT250025

100x32 ONHX100S12 12x40 160

100x38 ONHX100L15 15x46 200

125x40 ONHX125L15 15x46 225 ONHT125L15 15x47 30 225

160x50 ONHX160L20 20x60 300 ONHT160L20 20x61 40 300

200x50 ONHX200020 20x60 350 ONHT200020 20x61 40 400

### FEATURES

They are made with high quality polypropylene and thermoplastic rubber coating, 70 Shore A hardness; ensuring complete protection of floors and a total absence of noise, resistant to most chemicals, ozone, UV, abrasion, fatigue and tear. The temperature range is from -10°C to +50°C.

### ŠČITNIKI OD 100 DO 200



### FHN

ART. (CODE)					
80 FH (26080H00)	80	35	40	8	150
100 FH (26100H00)	100	32	40	8	150
125 FH (26125H00)	125	38	45	8	180
160 FH (26160H00)	160	48	58	12	250
200 FH (26200H00)	200	50	58	12	300
250FH ((01486NK)	250	40	59	12	300

