

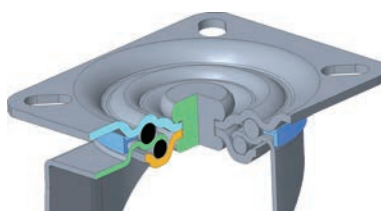

Tel: 04/257 68 20

Gsm: 040/99 00 11

Componenti in acciaio stampato zincati galvanicamente.  
Rotazione piastra su doppia corona di sfere in acciaio temperato.  
Piste rotazione sfere calibrate e lubrificate.  
Anello di protezione sfere antipolvere.  
Perno ribadito per assemblaggio supporto.  
Frenature integrali a pedale regolabile.



*Pressed steel, zinc-plated components.  
Double ball races with hardened steel balls.  
Calibrated and lubricated ball race tracks.  
Dust protection ring.  
Riveted or bolted central pin for assembling.  
Adjustable brake foot lever.*

girevole piastra / swivel castor



<b>80x25</b>	105x85	80x60	9x16	38	108		<b>1PGA0800GR0</b>	50	1PMB0800GR0	<b>1PMB0800GX0</b>	
<b>100x30</b>	105x85	80x60	9x16	38	128		<b>1PGA1000GR0</b>	70	1PMB1000GR0	<b>1PMB1000GX0</b>	
<b>125x37,5</b>	105x85	80x60	9x16	45	155		<b>1PGA1250GR0</b>	100	1PMB1250GR0	<b>1PMB1250GX0</b>	
<b>160x40</b>	135x110	105x80	11x16	55	199		<b>1PGA1600GR0</b>	135	1PMB1600GR0	<b>1PMB1600GX0</b>	
<b>180x50</b>	135x110	105x80	11x16	55	219		<b>1PGA1800GR0</b>	170	1PMB1800GR0	<b>1PMB1800GX0</b>	
<b>200x50</b>	135x110	105x80	11x16	55	239		<b>1PGA2000GR0</b>	205	1PMB2000GR0	<b>1PMB2000GX0</b>	

girevole piastra freno pedale anteriore regolabile / swivel castor with adjustable front brake foot lever



<b>80x25</b>	105x85	80x60	9x16	38	108	120	<b>1PGA0800GRI</b>	50	1PMB0800GRI	<b>1PMB0800GXI</b>	
<b>100x30</b>	105x85	80x60	9x16	38	128	120	<b>1PGA1000GRI</b>	70	1PMB1000GRI	<b>1PMB1000GXI</b>	
<b>125x37,5</b>	105x85	80x60	9x16	45	155	120	<b>1PGA1250GRI</b>	100	1PMB1250GRI	<b>1PMB1250GXI</b>	
<b>160x40</b>	135x110	105x80	11x16	55	199	140	<b>1PGA1600GRI</b>	135	1PMB1600GRI	<b>1PMB1600GXI</b>	
<b>180x50</b>	135x110	105x80	11x16	55	219	140	<b>1PGA1800GRI</b>	170	1PMB1800GRI	<b>1PMB1800GXI</b>	
<b>200x50</b>	135x110	105x80	11x16	55	239	140	<b>1PGA2000GRI</b>	205	1PMB2000GRI	<b>1PMB2000GXI</b>	

girevole foro per vite / bolt hole swivel castor



<b>80x25</b>	12	77		38	104		<b>1PGA0800QR0</b>	50	1PMB0800QR0	<b>1PMB0800QX0</b>
<b>100x30</b>	12	77		38	124		<b>1PGA1000QR0</b>	70	1PMB1000QR0	<b>1PMB1000QX0</b>
<b>125x37,5</b>	12	77		45	151		<b>1PGA1250QR0</b>	100	1PMB1250QR0	<b>1PMB1250QX0</b>
<b>160x40</b>	16	103		55	193		<b>1PGA1600QR0</b>	135	1PMB1600QR0	<b>1PMB1600QX0</b>
<b>180x50</b>	16	103		55	213		<b>1PGA1800QR0</b>	170	1PMB1800QR0	<b>1PMB1800QX0</b>
<b>200x50</b>	16	103		55	233		<b>1PGA2000QR0</b>	205	1PMB2000QR0	<b>1PMB2000QX0</b>

girevole foro per vite freno pedale anteriore regolabile / bolt hole swivel castor with adjustable front brake foot lever



<b>80x25</b>	12	77		38	104	120	<b>1PGA0800QRI</b>	50	1PMB0800QRI	<b>1PMB0800QXI</b>	
<b>100x30</b>	12	77		38	124	120	<b>1PGA1000QRI</b>	70	1PMB1000QRI	<b>1PMB1000QXI</b>	
<b>125x37,5</b>	12	77		45	151	120	<b>1PGA1250QRI</b>	100	1PMB1250QRI	<b>1PMB1250QXI</b>	
<b>160x40</b>	16	103		55	193	140	<b>1PGA1600QRI</b>	135	1PMB1600QRI	<b>1PMB1600QXI</b>	
<b>180x50</b>	16	103		55	213	140	<b>1PGA1800QRI</b>	170	1PMB1800QRI	<b>1PMB1800QXI</b>	
<b>200x50</b>	16	103		55	233	140	<b>1PGA2000QRI</b>	205	1PMB2000QRI	<b>1PMB2000QXI</b>	

Varianti/Options

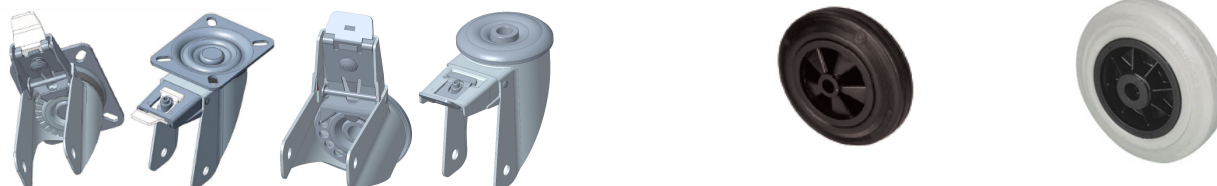

Vilice po naročilu tudi v INOX izvedbi!



fisso piastra / fixed castor



<b>80x25</b>	105x85	80x60	9x16	108	<b>1PGA0800FIO</b>	50	1PMB0800FIO	<b>1PMB0800FX0</b>	
<b>100x30</b>	105x85	80x60	9x16	128	<b>1PGA1000FIO</b>	70	1PMB1000FIO	<b>1PMB1000FX0</b>	
<b>125x37,5</b>	105x85	80x60	9x16	155	<b>1PGA1250FIO</b>	100	1PMB1250FIO	<b>1PMB1250FX0</b>	
<b>160x40</b>	135x110	105x80	11x16	199	<b>1PGA1600FIO</b>	135	1PMB1600FIO	<b>1PMB1600FX0</b>	
<b>180x50</b>	135x110	105x80	11x16	219	<b>1PGA1800FIO</b>	170	1PMB1800FIO	<b>1PMB1800FX0</b>	
<b>200x50</b>	135x110	105x80	11x16	239	<b>1PGA2000FIO</b>	205	1PMB2000FIO	<b>1PMB2000FX0</b>	

**Varianti/Options**





### RUOTE NUCLEO TERMOPLASTICO ANELLO GOMMA NERA STANDARD PLASTIC CENTRE WHEELS WITH BLACK STANDARD RUBBER TYRE

#### Caratteristiche Ruota

Anello in gomma nera qualità standard. Struttura portante in materiale plastico antiurto colore nero.  
Movimento mozzo:  
alesaggio passante  
gabbia a rulli  
Temperatura d'impiego da -10°C a +60°C. Discreta resistenza agli aggressivi chimici. Durezza battistrada 83 Sh.A +/- 4 Discreta resistenza all'abrasione. Velocità massima di lavoro 4 km/h. Mezzo di trazione consigliato: manuale

#### Wheel Features

Black standard rubber tyre.  
Shock resistant black plastic centre wheel.  
Type of bearing:  
plain bearing  
roller bearing.  
Temperature range: from -10°C to +60°C.  
Fair resistance to chemicals.  
Tread hardness 83 Sh.A +/- 4  
Fair resistance to abrasion  
Max. working speed 4 km/h  
Operation : manual



#### Pavimentazioni Idonee / Floring Type



80x25	OPGA080012	12x40	50
100x30	OPGA100012	12x40	70
125x37,5	OPGA125015	15x46	100
160x40	OPGA160020	20x60	135
180x50	OPGA180020	20x60	170
200x50	OPGA200020	20x60	205

Anello in gomma grigia qualità standard. Struttura portante in materiale plastico antiurto colore grigia.  
Movimento mozzo:  
alesaggio passante  
gabbia a rulli  
Temperatura d'impiego da -10°C a +60°C.  
Discreta resistenza agli aggressivi chimici.  
Durezza battistrada 83 Sh.A +/- 4  
Discreta resistenza all'abrasione.  
Velocità massima di lavoro 4 km/h.  
Mezzo di trazione consigliato: manuale

Grey standard rubber tyre.  
Grey elastic rubber tyre.  
Shock resistant grey plastic centre wheel.  
Type of bearing:  
self-lubricating polyamide bush.  
roller bearing  
roller bearing with steel tube.  
Temperature range: from -10°C to +60°C.  
Fair resistance to chemicals.  
Tread hardness 83 Sh.A +/- 4.  
Fair resistance to abrasion.  
Max. working speed 4 km/h.  
Operation: manual.



80x25	OPMB080012	12x40	50
100x30	OPMB100012	12x40	70
125x37,5	OPMB125015	15x46	100
160x40	OPMB160020	20x60	135
180x50	OPMB180020	20x60	170
200x50	OPMB200020	20x60	205

#### Varianti / Options

Le dimensioni riportate sulle pagine del nostro catalogo sono espresse in millimetri  
All dimensional sizes shown on our catalogue are in millimeters.