

Tel: 04/257 68 20

Gsm: 040/99 00 11

Componenti in acciaio stampato zincati galvanicamente.
Rotazione piastra su doppia corona di sfere in acciaio temperato.

Piste rotazione sfere calibrate e lubrificate.

Anello di protezione sfere antipolvere.

Perno ribadito per assemblaggio supporto.

Frenature integrali a pedale regolabile.

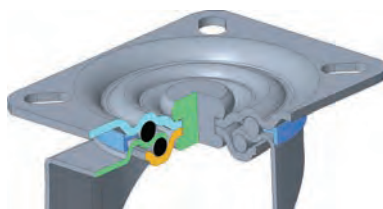

Pressed steel, zinc-plated components.
Double ball races with hardened steel balls.
Calibrated and lubricated ball race tracks.
Dust protection ring.
Riveted or bolted central pin for assembling.
Adjustable brake foot lever.

girevole piastra / swivel castor



							COD		ZINC		INOX
80x32	105x85	80x60	9x16	38	108		1SPR0800GR0	70	1EDN0800GR0	80	1EDN0800GX0
100x34	105x85	80x60	9x16	38	128		1SPR1000GR0	100	1EDN1000GR0	90	1EDN1000GX0
125x37,5	105x85	80x60	9x16	45	155		1SPR1250GR0	130	1EDN1250GR0	100	1EDN1250GX0
160x40	135x110	105x80	11x16	55	199		1SPR1600GR0	160	1EDN1600GR0	160	1EDN1600GX0
200x50	135x110	105x80	11x16	55	239		1SPR2000GR0	190	1EDN2000GR0	190	1EDN2000GX0

girevole piastra freno pedale anteriore regolabile / swivel castor with adjustable front brake foot lever



							COD				
80x32	105x85	80x60	9x16	38	108	120	1SPR0800GRI	70	1EDN0800GRI	80	1EDN0800GX1
100x34	105x85	80x60	9x16	38	128	120	1SPR1000GRI	100	1EDN1000GRI	90	1EDN1000GX1
125x37,5	105x85	80x60	9x16	45	155	120	1SPR1250GRI	130	1EDN1250GRI	100	1EDN1250GX1
160x40	135x110	105x80	11x16	55	199	140	1SPR1600GRI	160	1EDN1600GRI	160	1EDN1600GX1
200x50	135x110	105x80	11x16	55	239	140	1SPR2000GRI	190	1EDN2000GRI	190	1EDN2000GX1

girevole foro per vite / bolt hole swivel castor



							COD				
80x32	12	77		38	104		1SPR0800QR0	70	1EDN0800QR0	80	1EDN0800QX0
100x34	12	77		38	124		1SPR1000QR0	100	1EDN1000QR0	90	1EDN1000QX0
125x37,5	12	77		45	151		1SPR1250QR0	130	1EDN1250QR0	100	1EDN1250QX0
160x40	16	103		55	193		1SPR1600QR0	160	1EDN1600QR0	160	1EDN1600QX0
200x50	16	103		55	233		1SPR2000QR0	190	1EDN2000QR0	190	1EDN2000QX0

fisso piastra / fixed castor



							COD				
80x32	105x85	80x60	9x16		108		1SPR0800FIO	70	1EDN0800FIO	80	1EDN0800FX0
100x34	105x85	80x60	9x16		128		1SPR1000FIO	100	1EDN1000FIO	90	1EDN1000FX0
125x37,5	105x85	80x60	9x16		155		1SPR1250FIO	120	1EDN1250FIO	100	1EDN1250FX0
160x40	135x110	105x80	11x16		199		1SPR1600FIO	160	1EDN1600FIO	160	1EDN1600FX0
200x50	135x110	105x80	11x16		239		1SPR2000FIO	190	1EDN2000FIO	190	1EDN2000FX0



Po naročilu možnost v INOX izvedbi.

Zaradi napetega dela v tekalnem delu, lažje obračanje!

RUOTE NUCLEO POLIPROPILENE ANELLO GOMMA SINTETICA GRIGIA
POLYPROPYLENE CENTRE WHEELS WITH GREY SYNTHETIC RUBBER
TYRES

Caratteristiche Ruota

Anello in gomma sintetica grigia.
Struttura portante in polipropilene antiurto colore grigio.
Doppi dischi parafili.
Movimento mozzo: gabbia a rulli.
Temperatura d'impiego da -10°C a +60°C.
Discreta resistenza agli aggressivi chimici.
Durezza battistrada 85 Sh.A +/- 3.
Discreta resistenza all'abrasione.
Velocità massima di lavoro 4 km/h.
Mezzo di trazione consigliato: manuale.

Wheel Features

Grey synthetic rubber tyre.
Grey shock resistant polypr. centre wheel.
Double tread guards.
Type of bearing: roller bearing.
Temperature range: from -10°C to +60°C.
Fair resistance to chemicals.
Tread hardness 85 Sh.A +/- 3.
Fair resistance to abrasion.
Max. working speed 4 KPH.
Operation: manual.



Pavimentazioni Idonee / Floring Type



80x32	OSPR080008	8x42,5	70
100x34	OSPR100008	8x42,5	100
125x37,5	OSPR125010	10x49	130
160x40	OSPR160012	12x60,5	160
200x50	OSPR200012	12x62,5	190

Kolo namenjeno za servirne vozičke.
Z mehko visoko penasto gumo.



Technical Data		Technische Daten	
Wheel diameter	100 mm	Rad-Ø	125 mm
Width of Tread	30 mm	Radbreite	30 mm
Axle Hole-Ø	8 mm	Achsloch-Ø	8 mm
Hub length	36.5 mm	Nabenlänge	36.5 mm
Temperature	- 20 / + 60 °C	Temperaturbereich	- 20 / + 60 °C
Standard	EN 12530	Norm	EN 12530
Weight	0.14 kg	Eigengewicht	0.212 kg
Hardness of tread	Shore A 70	Härte der Lauffläche	Shore A 70
Load capacity	60 kg	Tragfähigkeit	75 kg
Load capacity (static)	120 kg	Tragfähigkeit (statisch)	150 kg

Varianti / Options

Le dimensioni riportate sulle pagine del nostro catalogo sono espresse in millimetri
All dimensional sizes shown on our catalogue are in millimeters.

RUOTE NUCLEO TERMOPLASTICO ANELLO GOMMA SINTETICA GRIGIA

PLASTIC CENTRE WHEELS WITH GREY SYNTHETIC RUBBER TYRES

Caratteristiche Ruota

- Anello in gomma sintetica grigia.
- Struttura portante colore grigio in materiale plastico
- Doppi dischi parafili
- Movimento mozzo: alesaggio passante.
- monocuscinetto a tenuta stagna
- doppi cuscinetti a tenuta stagna.
- Temperatura d'impiego da -20°C a +70°C.
- Discreta resistenza agli aggressivi chimici.
- Durezza battistrada 85 Sh.A +/- 5
- Buona resistenza all'abrasione.
- Velocità massima di lavoro 4 km/h.
- Movimentazione manuale.

Wheel features

- Grey synthetic rubber tyre
- Plastic material centre wheels.
- Thread guards
- Type of bearing: plain bearing
- roller bearing.
- single waterproof ball bearing.
- double waterproof ball bearing.
- Temperature range: from -20°C to +70°C.
- Fair resistance to chemicals.
- Tread hardness 85 Sh.A +/- 5.
- Good resistance to abrasion.
- Max working speed 4 km/h.
- Operation: manual.



Modalità di impiego/ Main features

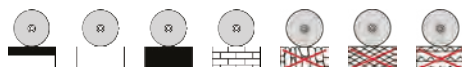

80x32	2EDA080A08	8x42	70	2EDN080A08E	8x42	80
100x32	2EDA100A08	8x42	90	2EDN100A08E	8x42	90
125x32	2EDA125A10	10x49	100	2EDN125A10	10x49	100
125x46				OEDT125B12	12x63	160
160x46				OEDT160012	12x63	220
200x50				OEDT200A12	12x63	300



Zaradi napetega dela v tekalnem delu, lažje obračanje!

Varianti/Options

Accessori/Accessories

Le dimensioni riportate sulle pagine del nostro catalogo sono espresse in millimetri
All dimensional sizes shown on our catalogue are in millimeters.