

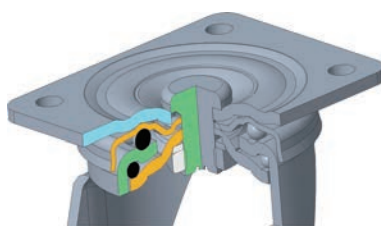

SERIE P

Componenti in acciaio stampato di notevole spessore zincati galvanicamente.
Rotazione piastra su doppia corona di sfere in acciaio stampato e calibrato.
Perno imbullonato alta resistenza per assemblaggio supporto.
Lubrificazione particolare per temperature da -15°C a +130°C.
Frenatura integrale a pedale posteriore.
Alta capacità di carico.



*High thickness, pressed steel, zinc-plated components.
Double ball races with pressed and calibrated steel balls.
High-resistance, bolted central pin for assembling.
Special lubrication for use at temperatures from 15°C to +130°C.
Rear foot lever total brake.
High load capacity.*

girevole piastra / swivel castor



								COD	
125x62	140x110	105x80	12,5	46	12x62	116		SGP0125DC0	1000
160x62	140x110	105x80	12,5	52	12x62	132		SGP0160DC0	1000
200x62	140x110	105x80	12,5	58	12x62	153		SGP0200DC0	1000
300x82	200x160	160x120	14	85	18x82	200		SGP0300EG0	1500

girevole piastra freno pedale posteriore / swivel castor with rear brake foot lever



									COD	
125x62	140x110	105x80	12,5	46	12x62	116	127		SGPN125DC9	1000
160x62	140x110	105x80	12,5	52	12x62	132	127		SGPN160DC9	1000
200x62	140x110	105x80	12,5	58	12x62	153	127		SGPN200DC9	1000
300x82	200x160	160x120	14	85	18x82	200	127		SGPN300EG9	1500

fisso piastra / fixed castor



								COD	
125x62	135x110	105x80	11x16		12x62	117		SFM0160AC0	1300
160x62	135x110	105x80	11x16		12x62	132		SFM01800C0	1300
200x62	135x110	105x80	11x16		12x62	150		SFM0200AC0	1300
300x82	200x160	160x120	14		18x82	200		SFP0300EG0	1500